

GROUND FLOOR

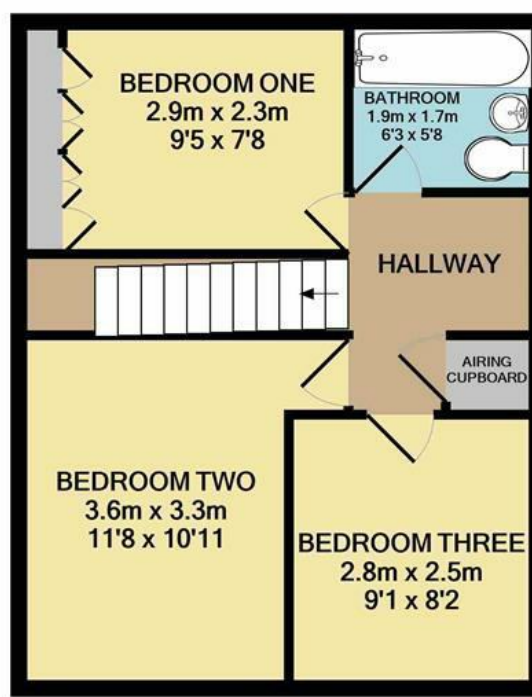

1ST FLOOR

Whilst every attempt has been made to ensure the accuracy of the floor plan contained here, measurements of doors, windows, rooms and any other items are approximate and no responsibility is taken for any error, omission, or mis-statement. This plan is for illustrative purposes only and should be used as such by any prospective purchaser. The services, systems and appliances shown have not been tested and no guarantee as to their operability or efficiency can be given
Made with Metropix ©2021

Energy Efficiency Rating		Current	Potential
Very energy efficient - lower running costs			
(92 plus)	A		
(81-91)	B		
(69-80)	C		
(55-68)	D		
(39-54)	E		
(21-38)	F		
(1-20)	G		
Not energy efficient - higher running costs			
England & Wales		EU Directive 2002/91/EC	

Disclaimer – In accordance with the Property Misdescriptions Act, the company gives notice that all descriptions, references to condition, necessary permissions for use and other details are given in good faith and believed to be correct, but any intending lessees do not rely on them as statements of fact, but must satisfy themselves by inspection or other means, as to their accuracy.



Norman Drive | Norwich | NR6
Guide Price £240,000



abbotFox present this fantastic three-bedroom semi detached home located in the popular suburb of Old Catton. Ground floor accommodation offering an entrance porch, generous lounge, extended modern kitchen diner with all built in appliances, with back door access as well as french doors leading to a covered decking area. On the first floor, three bedrooms and bathroom off landing. Externally, a large south facing garden, with storage shed and garage both with including power.

Guide price £240,000 - £250,000

